

# DAGGER

SUSPENDED

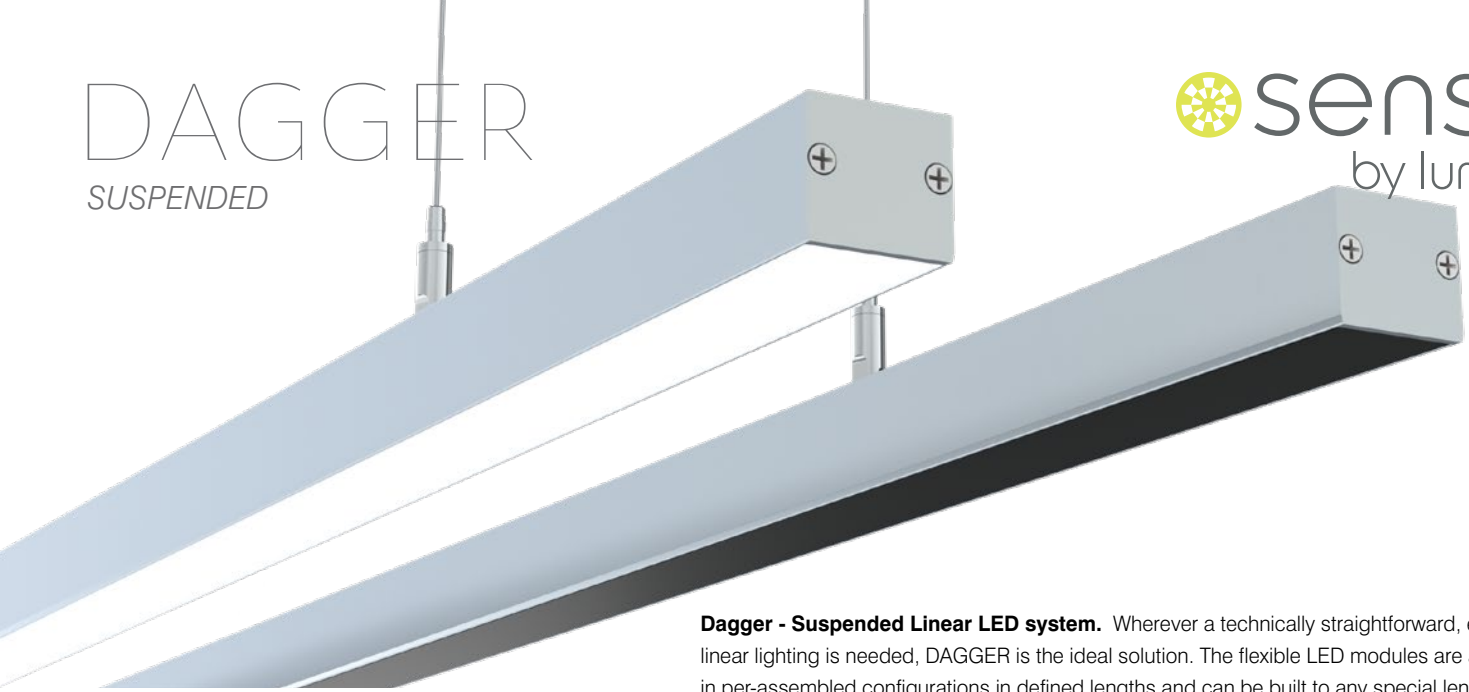

**Dagger - Suspended Linear LED system.** Wherever a technically straightforward, economic linear lighting is needed, DAGGER is the ideal solution. The flexible LED modules are available in per-assembled configurations in defined lengths and can be built to any special length for the clients requirements. This not only offers tremendous advantages for installation but also ensures the look you designed the linear lighting into the space.

## Ordering Code

Fixture	<b>565</b>	<b>136</b>							
	1	2	3	4	5	6	7	8	9
Driver			<b>24</b>						
	1	2	3	4	5	6			

## Product Specifications

**SAMPLE :** Fixture **565 - 136 - 500 - 02 - 030 - 27 - 5 - 6'** | Driver **953 - 02 - 24 - 060 - STD - 120**

1 - Type	2 - Model	3 - Lens	4 - LED Style <sup>*1/3</sup>				
<b>565</b> · Profile	<b>136</b> · Dagger Suspended	<b>500</b> · Frosted <b>502</b> · Clear <b>512</b> · Black	Eco <b>030</b> · 110 <b>060</b> · 207 <b>095</b> · 329 <b>120</b> · 433	Pro 56 <b>062</b> · 194 <b>117</b> · 376 <b>167</b> · 540 <b>219</b> · 706	Pro 112 <b>122</b> · 383 <b>175</b> · 559 <b>221</b> · 742 <b>271</b> · 910 <b>382</b> · 1235	Controlled White <sup>*2</sup> <b>CT1</b> · 1059	RGB <sup>*2</sup> <b>RGB</b> · RGB <b>RGBW</b> · RGB+W

5 - CCT				6 - Finish	7 - Backplate	8 - Suspension Length	9 - Fixture Length <sup>*3</sup>
Eco <b>27</b> · 2700K <b>32</b> · 3200K <b>41</b> · 4100K	Pro 80 CRI <b>22</b> · 2200K <b>25</b> · 2500K	Pro 90 CRI <b>27</b> · 2700K <b>30</b> · 3000K <b>35</b> · 3500K <b>40</b> · 4000K <b>50</b> · 5000K	Controlled White <sup>*2</sup> <b>CT1</b> · 2000 - 5700K RGB <sup>*2</sup> <b>98</b> · RGB <b>99</b> · RGB+W	<b>01</b> · White <b>02</b> · Black <b>08</b> · Silver <b>XX</b> · Custom	<b>0</b> · None <b>B</b> · Backplate	<b>5</b> · 5' <b>8</b> · 8' <i>Contact SENSO for custom length</i>	<b>XX</b> · Custom (XX.XX) <i>Continuous runs will be made in equal sections no more than 8' long</i>

1 - Canopy	2 - Canopy Color	3 - Output Voltage	4 - Wattage	5 - Driver	Dim Level	6 - Input Voltage
<b>921</b> · Remote driver <b>953</b> · Integrated Driver	<b>01</b> · White <b>02</b> · Black <b>08</b> · Silver <b>XX</b> · Custom	<b>24</b> · 24V	<b>060</b> · 60W <b>096</b> · 96W	<b>STD</b> · Standard Driver <b>DIM</b> · Magnetic Driver <sup>*4</sup> <b>LCS</b> · 0 - 10 Volt Protocol <sup>*5</sup> <b>DALI</b> · Dali Protocol <sup>*5/6</sup> <b>DMX</b> · SENSO <sup>*5</sup> <b>LUTRON</b> · Lutron CV <sup>*5/6</sup>	N/A 1% 1% 0.1% 1% 0.1%	<b>120</b> · 120V <b>277</b> · 277V <b>347</b> · 347V <sup>*5/7</sup>

\*1 Measured in Lm/ft

\*2 DMX driver required

\*3 Refer to page 2 for LED cut length intervals

\*4 120V only

\*5 Remote driver required

\*6 Only available in 96W

\*7 Not available in DALI, LUTRON or DMX

## 24V Linear LED Light Source

	STYLE	WATT/FT	LUMENS/FT	CRI	MAX. LENGTH	CUT LENGTH	LED/FT	Color TEMPERATURE	DESCRIPTION
<b>ECO</b>	<b>030</b>	1.46	110	83	16.4'	3.94"	18	2700K, 3200K, 4100K	Versatile strip with 3 LED densities, 3 color temperatures and a CRI of 83
	<b>060</b>	2.93	207	83	16.4'	1.97"	36		
	<b>095</b>	4.39	329	83	16.4'	3.94"	18		
	<b>120</b>	5.85	433	83	16.4'	0.98"	73		
<b>PRO 56</b>	<b>062</b>	1.5	194	80/90	32.8'	4.92"	17	80 CRI 2200K, 2500K	Even LED layout (56 led/m - 17 led/ft) for balanced performance and efficiency
	<b>117</b>	2.9	376	80/90	16.4'	4.92"	17		
	<b>167</b>	4.4	540	80/90	13.1'	4.92"	17		
	<b>219</b>	5.9	706	80/90	9.84'	4.92"	17		
<b>PRO 112</b>	<b>122</b>	2.9	383	80/90	23.0'	2.46"	34	90 CRI 2700K, 3000K, 3500K, 4000K, 5000K	Dense LED layout (112 led/m - 34 led/ft) creates no dots with frosted lens
	<b>175</b>	4.4	559	80/90	14.75'	2.46"	34		
	<b>221</b>	5.9	742	80/90	11.5'	2.46"	34		
	<b>271</b>	7.3	910	80/90	9.8'	2.46"	34		
<b>Controlled White</b>	<b>CT1</b>	10.67	1059	85	14.75'	3.54"	40	2000K - 5700K	Color Tunable led strip with a warm/cool range from 2000K to 5700K
<b>RGB</b>	<b>RGB</b>	4.39	204	-	16.4'	3.94"	18	-	Individually control Red, Green, Blue and White (white only with RGB+W)
	<b>RGB+W</b>	6.78	364	-	10.7'	3.54"	81		

\* Lumen output based on 3000K / 90CRI. For other output information, please consult SENSO.

## Key LED Strip Features

- 3 STEP MacAdam LEDs or Single Bin LEDs
- Stabilized current design
- LED strip efficacy up to 171 lm/W
- Only 8 mm width
- 24V DC voltage input
- Reverse voltage protection
- Thermal conductive adhesive on back side for better heat conduction
- 50,000 hour life expectancy

## Lens/Light Distribution

part number **500** (frosted 65% transparent)  
**502** (clear 95% transparent)

- PMMA construction
- Easily clipped in profile
- Comes pre-cut to match profile length
- Flush

Clear Lens

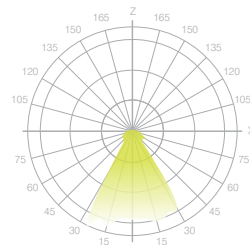

Frosted Lens

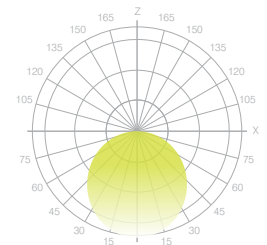

# DAGGER

SUSPENDED

## Installation

- Factory assembled for easy and fast installation
- Easy wiring, profiles sections connect directly to each other via connectors (or using a connector equipped jumped wire)
- Caps included

## Construction

- Powder coated in white, black or silver
- Housing: Aluminum extrusion
- Made in Canada

## Dimensions

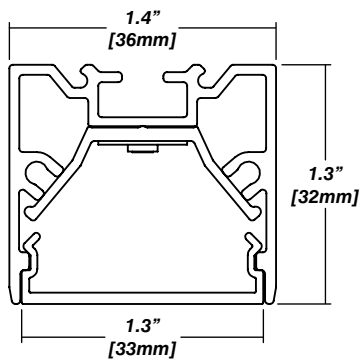

## Backplate

Dagger with Lid

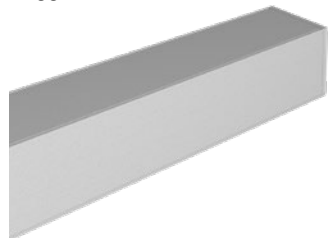

Dagger without Lid



## Remote Driver Canopy

part number **921**

- Aluminum feed canopy
- Aircraft cable holder
- For remote driver mounting only
- W - Ø5" [125mm]
- H - 0.65" [16.7mm]



## Canopy with Driver

part number **953**

- Extruded aluminum cover
- Machined aluminum connector
- Aircraft cable holder
- Cable and driver included
- Input voltage 120V - 277V (DIM 120V only)
- Output up to 96W and 24V
- WxL - 7.7" [195mm] x 5.4" [138mm]
- H - 1.6" [40mm]



## Joining Sections

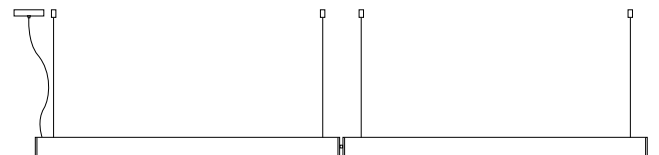
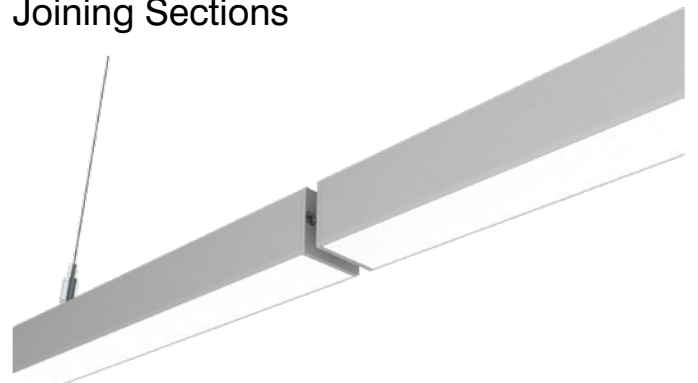

## Drivers for Linear Aluminum Profile

### Driver Data

Driver	Output Voltage	Input voltage	Wattage	Efficiency @ Max Load	Power Factor	Dim Level	Dim Protocol
<b>STD</b>	24V	120V, 277V, 347V	60W, 96W	86%	>0.90	N/A	N/A
<b>DIM</b>		120V	60W, 96W	>90%	>0.95	1%	Magnetic
<b>LCS</b>		120V, 277V, 347V	60W, 96W	>87%	>0.95	10%	0-10V
<b>DALI</b>		120V, 277V	96W	>0.94	0.1%	DALI	
<b>DMX</b>		120V, 277V	60W, 96W	1%	DMX		
<b>LUTRON</b>		120V, 277V	96W	90%	>0.99	0.1%	ECO System

### Features

- CSA Approved
- Class 2, Class P
- Auto-reset protection for short circuit and over-temperature
- Overload protection

### STD / DMX

DMX requires decoder

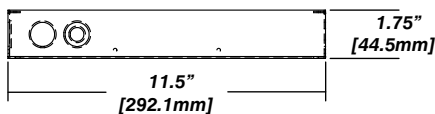
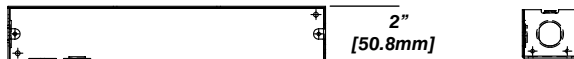

### LCS

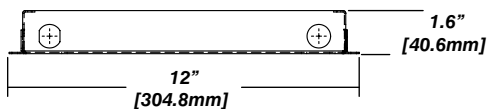
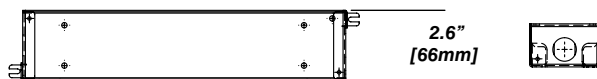

### 347V

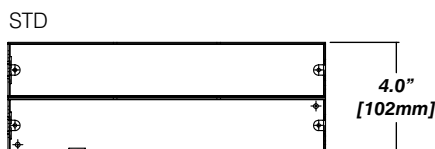

### DALI

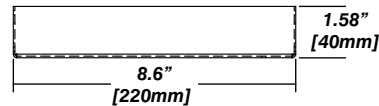
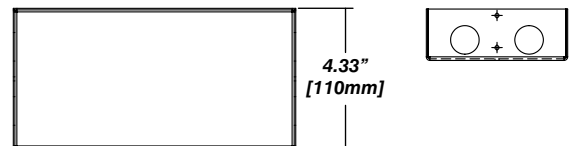

### LUTRON

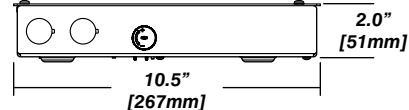
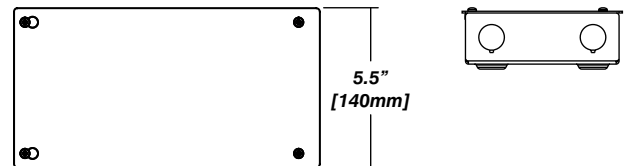

### DIM

